





LEGEND:

-  FIRE EXTINGUISHER
-  FIRE HOSE
-  WET/DRY STAND PIPE
-  FIRE LANE

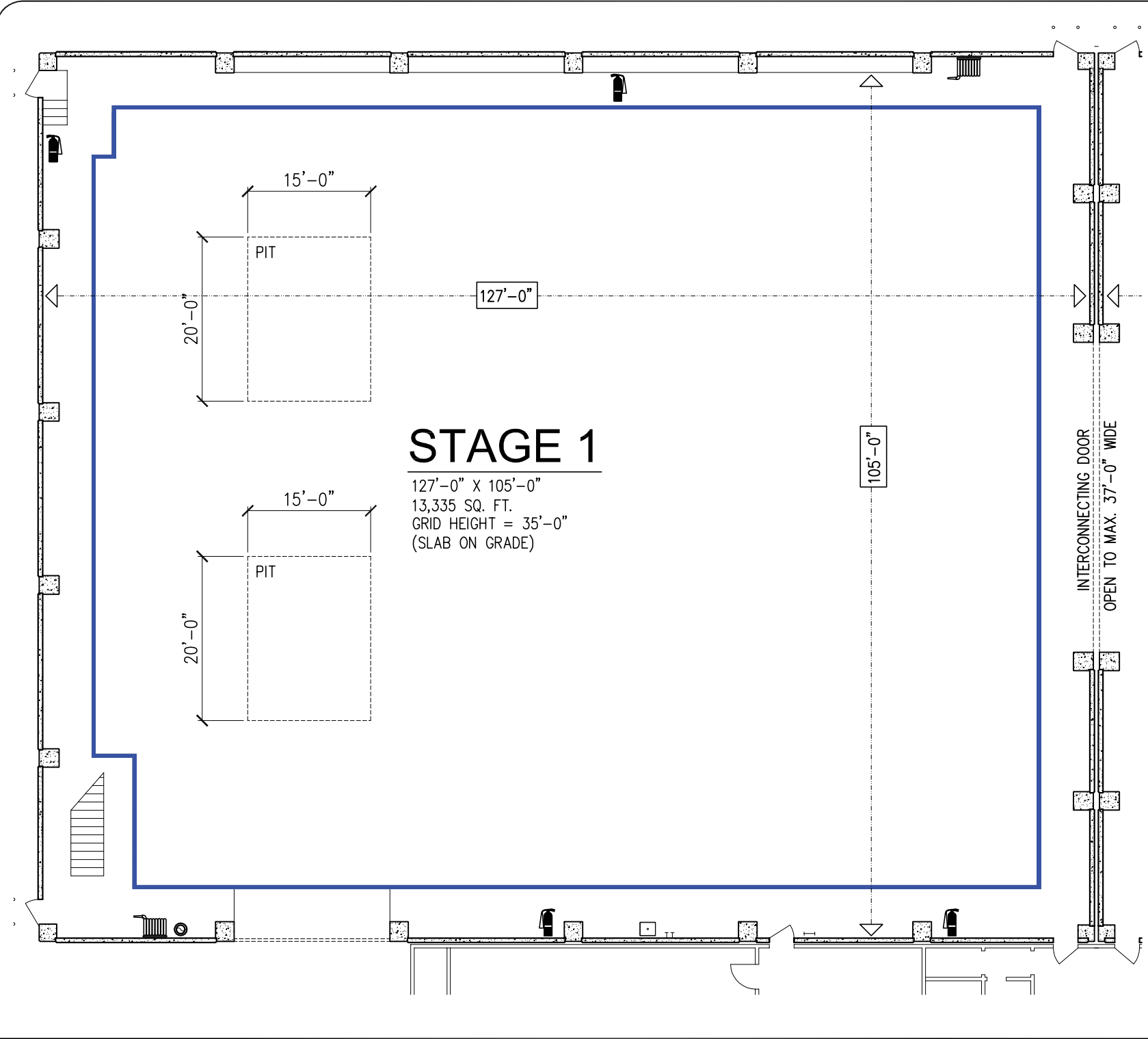

STAGE 1

127'-0" X 105'-0"
 13,335 SQ. FT.
 GRID HEIGHT = 35'-0"
 (SLAB ON GRADE)

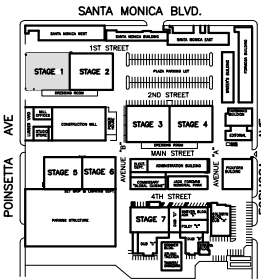

STAGE 1

SCALE 1/16"=1'-0"

THE LOT
 1041 North Formosa Avenue
 West Hollywood California
 90046
 T (323) 850-3184 F (323) 850-3190

Stage 1: Specifications



Stage Specifications (Dimensions Include 4' Fire Lane)

Width: 127'
Length: 105'
Height (to Perms): 35'
Total Square Footage: 13,335 sf
Floor Type: Wood over concrete slab
Interconnecting Stage Door (H X W): 19' 7" X 35' 6"
Elephant Door (H X W): 19' 8" X 18' 7"

Support Space

Six (6), 13' X 9', attached dressing rooms located upstairs
One (1), 20' X 18', make-up / hair room with private bath adjacent to stage
Two (2) 18' X 17' 4", ante rooms; interior and exterior access

Electric Services

Build / Wrap Power: 600 amps
Pre-light / Shoot Power: 4,800 amps
Power in Grid: No

HVAC

40 Ton Cooling Only Package Unit
Redlight Control: Available
Ventilation: Yes
Heating: Available

Stage Extras

Water Hose Bib: Yes
Natural Gas: Yes
Slop Sink: Yes
Compressed Air: Yes
Wireless Internet: Available
Phone: Available
Fax: Available